

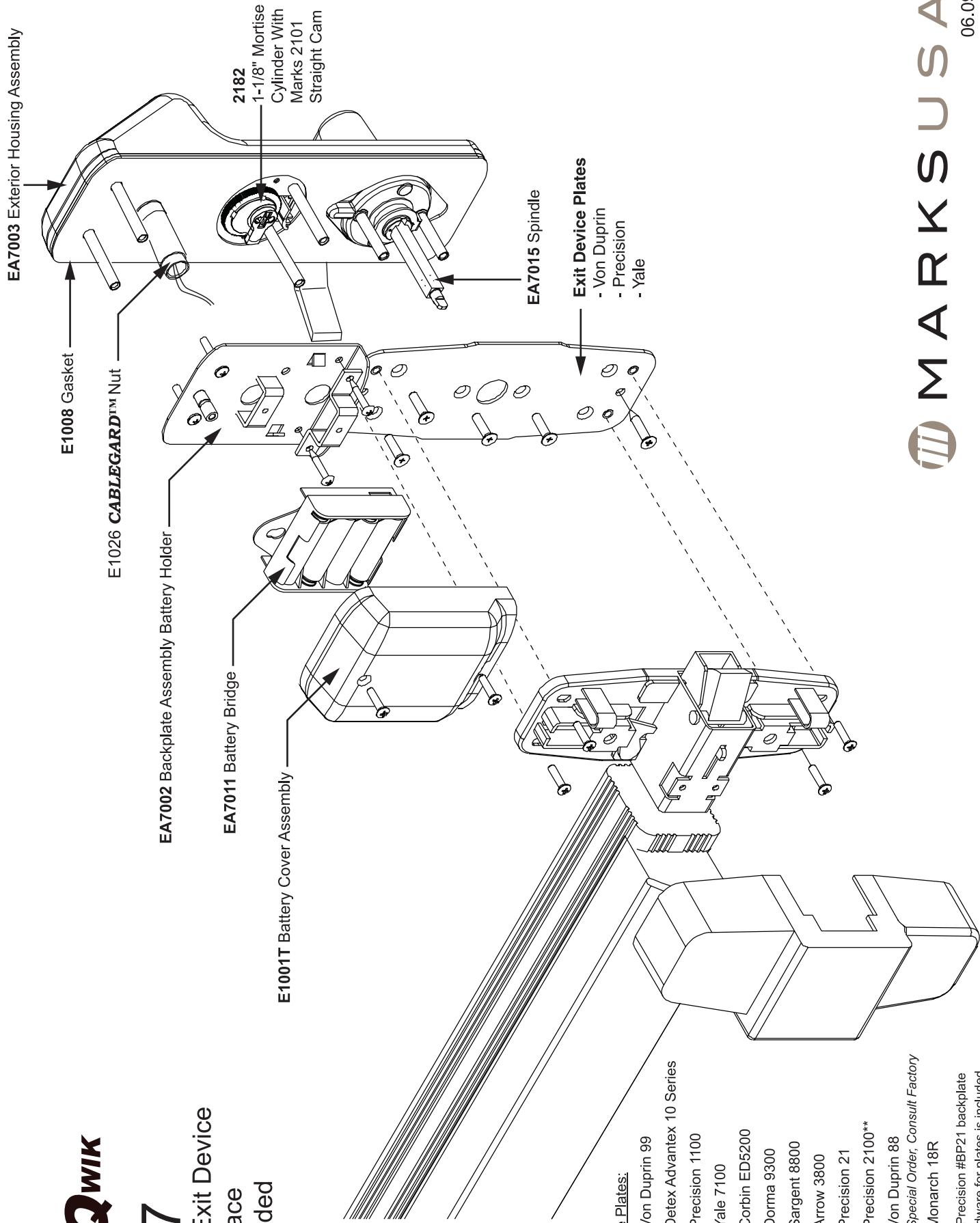

IQ7

Rim Exit Device Interface Exploded View



Exit Device Plates:

- E7071 Von Duprin 99
- E7071 Detex Advantex 10 Series
- E7072 Precision 1100
- E7073 Yale 7100
- E7073 Corbin ED5200
- E7074 Dorma 9300
- E7075 Sargent 8800
- E7075 Arrow 3800
- E7076 Precision 21
- E7076 Precision 2100**
- E7077 Von Duprin 88
Special Order, Consult Factory
- E7078 Monarch 18R

** Must use Precision #BP21 backplate
Note: All hardware for plates is included



MARKSUSA

06.09